



# MYNYDD MAEN WIND FARM

## FIGURE 10.3

### ABNORMAL LOAD ROUTE ABERCARN MOUNTAIN RD

© CROWN COPYRIGHT, ALL RIGHTS RESERVED.  
2023 LICENCE NUMBER 0100031673.

#### NOTES:

1. ANALYSIS CARRIED OUT FOR 117m ROTOR DIAMETER BLADE DELIVERY VEHICLE SUPER WIND CARRIER (REAR STEER VEHICLE).
2. AREAS OF OVERRUN AND OVERSAIL CONSIDER THE COMBINED AREA FOR ALL ASSESSED VEHICLES.
3. LAND TAKE IS APPROXIMATE AND INCLUDES OVERRUN, OVERSAIL AND TEMPORARY WORKS.
4. ALL RELEVANT AUTHORITIES TO BE CONSULTED ON RELOCATION / REMOVAL OF STREET FURNITURE.
5. VEGETATION TO BE TRIMMED BACK WHERE REQUIRED WITHIN HIGHWAY CORRIDOR.
6. FOLLOWING THE WIND FARM CONSTRUCTION PHASE, WIDENING WORK WILL BE REINSTATED AS SOON AS REASONABLY PRACTICABLE. IN THE UNLIKELY EVENT THAT A REPLACEMENT BLADE IS REQUIRED DURING THE OPERATIONAL PHASE, WIDENING WORK WILL BE TEMPORARILY REOPENED, AND REINSTATED FOLLOWING REPLACEMENT COMPLETION.
7. TOPOGRAPHICAL SURVEY DATA PROVIDED BY LMS - FEB 2022.

OVERVIEW  
SHEET 1 OF 7

LAYOUT DWG N/A T-LAYOUT NO. N/A

DRAWING NUMBER **04412-RES-ACC-DR-LO-009** REV **1**

SCALE - 1:5,000 @ A3

ENVIRONMENTAL STATEMENT  
2023

THIS DRAWING IS THE PROPERTY OF RENEWABLE ENERGY SYSTEMS LTD. AND NO REPRODUCTION MAY BE MADE IN WHOLE OR IN PART WITHOUT PERMISSION

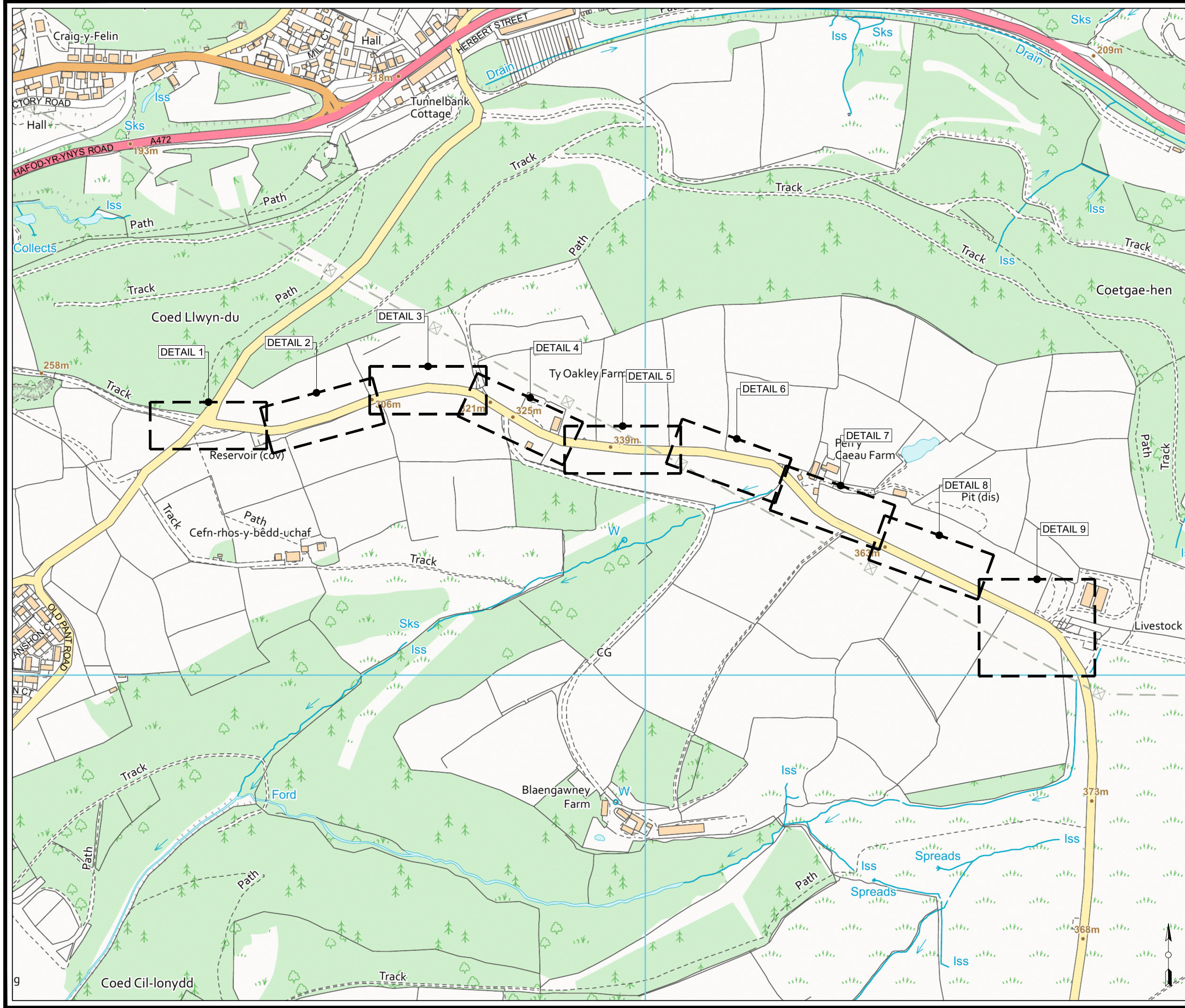

**MYNYDD MAEN  
WIND FARM**

**FIGURE 10.3**

**ABNORMAL LOAD ROUTE  
ABERCARN MOUNTAIN RD**

VEGETATION TO BE TRIMMED  
WHERE LOAD COMES INTO  
CONTACT WITH HEDGES/BUSHES

PALISADE FENCING  
SURROUNDING UTILITIES

DETAIL 1

- KEY:**
- EXISTING ROAD / TRACK SURFACE
  - PROPOSED ACCESS TRACK  
(ABNORMAL DELIVERY VEHICLES ONLY)
  - POTENTIAL ROAD WIDENING FOR  
ABNORMAL DELIVERY VEHICLES
  - PROPOSED PASSING BAY
- VEHICLE TRACKING:**
- WHEEL EXTENTS
  - CHASSIS/BODY EXTENTS
  - LOAD (BLADE) EXTENTS
  - DIRECTION OF DELIVERY

**NOTES:**  
REFER TO SHEET 1

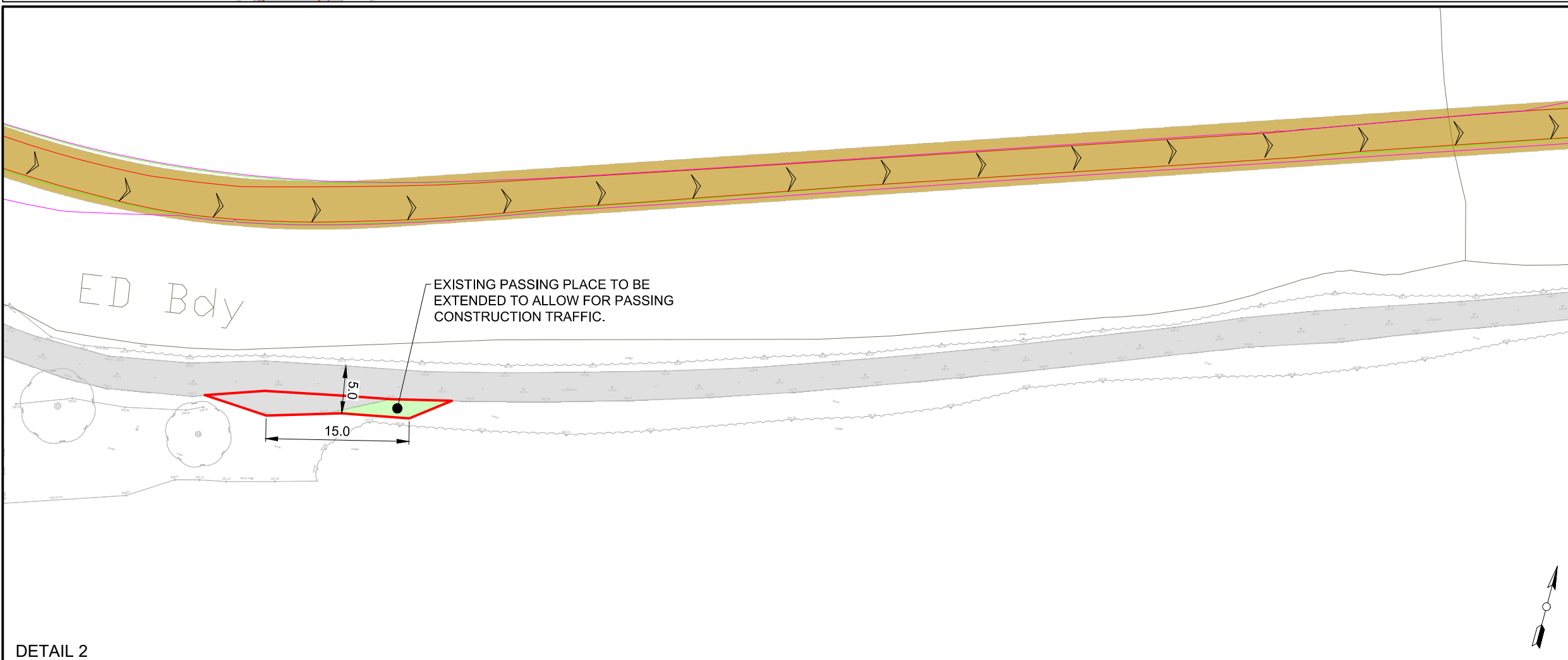

DETAIL 2

DETAIL 1 AND 2  
SHEET 2 OF 7

LAYOUT DWG	N/A	T-LAYOUT NO.	N/A
DRAWING NUMBER	04412-RES-ACC-DR-LO-009		REV 1

SCALE - 1:500 @ A3

**ENVIRONMENTAL STATEMENT  
2023**

THIS DRAWING IS THE PROPERTY OF RENEWABLE ENERGY SYSTEMS LTD. AND NO REPRODUCTION MAY BE MADE IN WHOLE OR IN PART WITHOUT PERMISSION

**MYNYDD MAEN  
WIND FARM**

**FIGURE 10.3**

**ABNORMAL LOAD ROUTE  
ABERCARN MOUNTAIN RD**

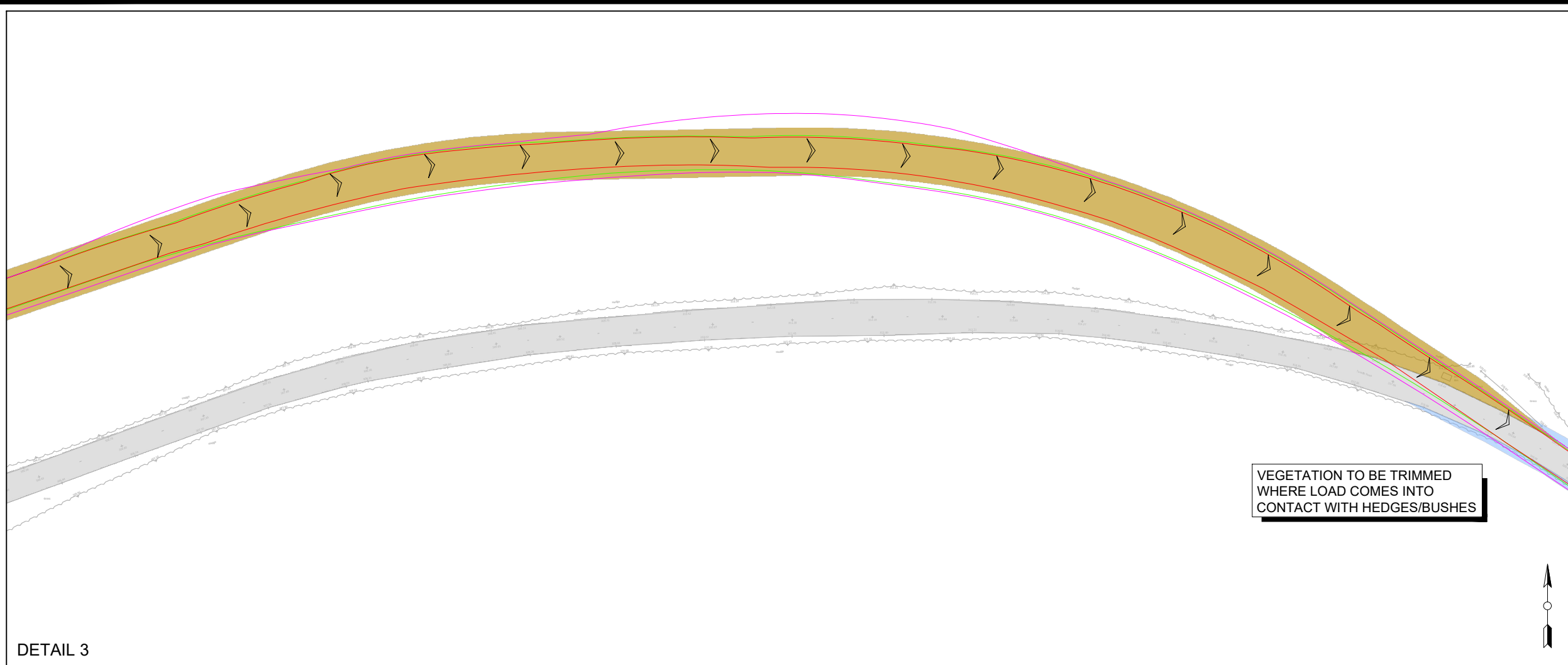

DETAIL 3

KEY:

- EXISTING ROAD / TRACK SURFACE
- PROPOSED ACCESS TRACK (ABNORMAL DELIVERY VEHICLES ONLY)
- POTENTIAL ROAD WIDENING FOR ABNORMAL DELIVERY VEHICLES
- PROPOSED PASSING BAY

VEHICLE TRACKING:

- WHEEL EXTENTS
- CHASSIS/BODY EXTENTS
- LOAD (BLADE) EXTENTS
- DIRECTION OF DELIVERY

NOTES:

REFER TO SHEET 1

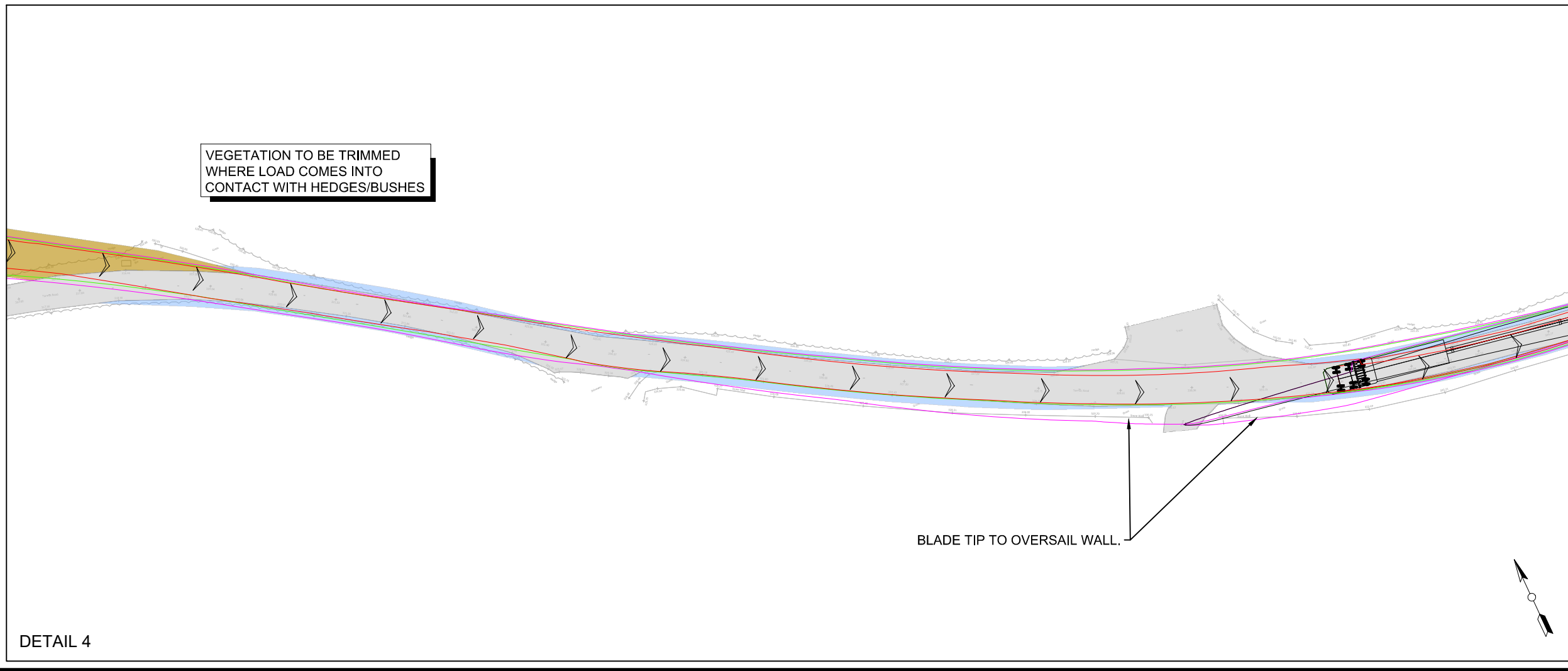

DETAIL 4

DETAIL 3 AND 4  
SHEET 3 OF 7

LAYOUT DWG	N/A	T-LAYOUT NO.	N/A
------------	-----	--------------	-----

DRAWING NUMBER	04412-RES-ACC-DR-LO-009	REV	1
----------------	-------------------------	-----	---

SCALE - 1:500 @ A3

**ENVIRONMENTAL STATEMENT  
2023**

THIS DRAWING IS THE PROPERTY OF RENEWABLE ENERGY SYSTEMS LTD. AND NO REPRODUCTION MAY BE MADE IN WHOLE OR IN PART WITHOUT PERMISSION

**MYNYDD MAEN  
WIND FARM**

**FIGURE 10.3**

**ABNORMAL LOAD ROUTE  
ABERCARN MOUNTAIN RD**

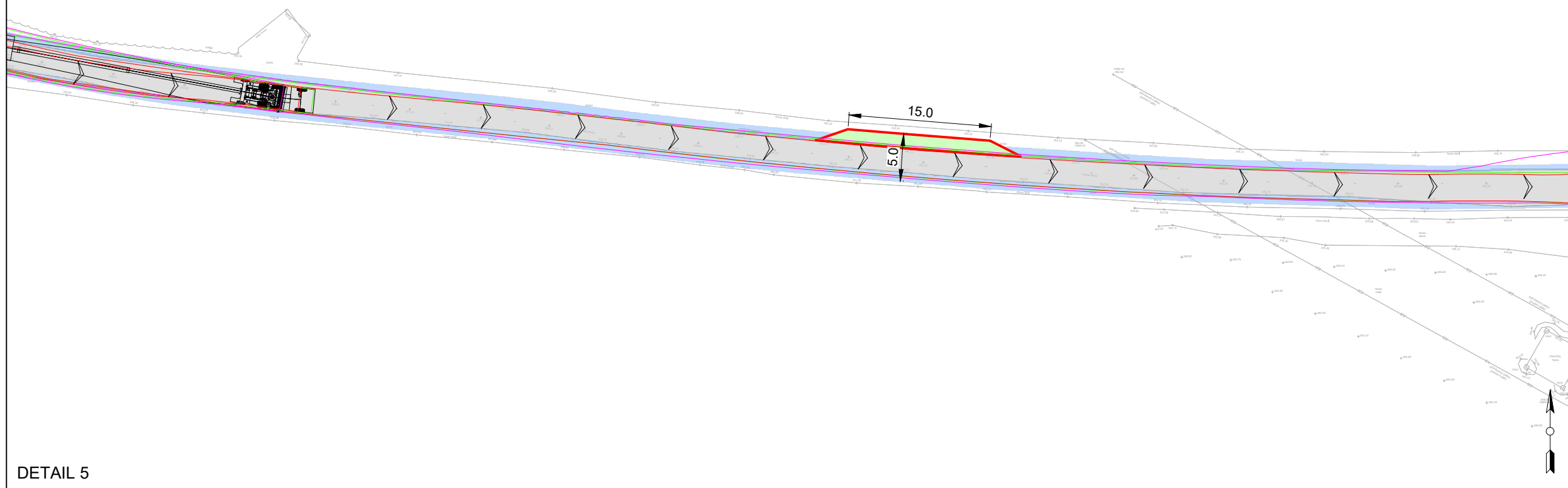

DETAIL 5

**KEY:**

- EXISTING ROAD / TRACK SURFACE
- PROPOSED ACCESS TRACK  
(ABNORMAL DELIVERY VEHICLES ONLY)
- POTENTIAL ROAD WIDENING FOR  
ABNORMAL DELIVERY VEHICLES
- PROPOSED PASSING BAY

**VEHICLE TRACKING:**

- WHEEL EXTENTS
- CHASSIS/BODY EXTENTS
- LOAD (BLADE) EXTENTS
- DIRECTION OF DELIVERY

**NOTES:**

REFER TO SHEET 1

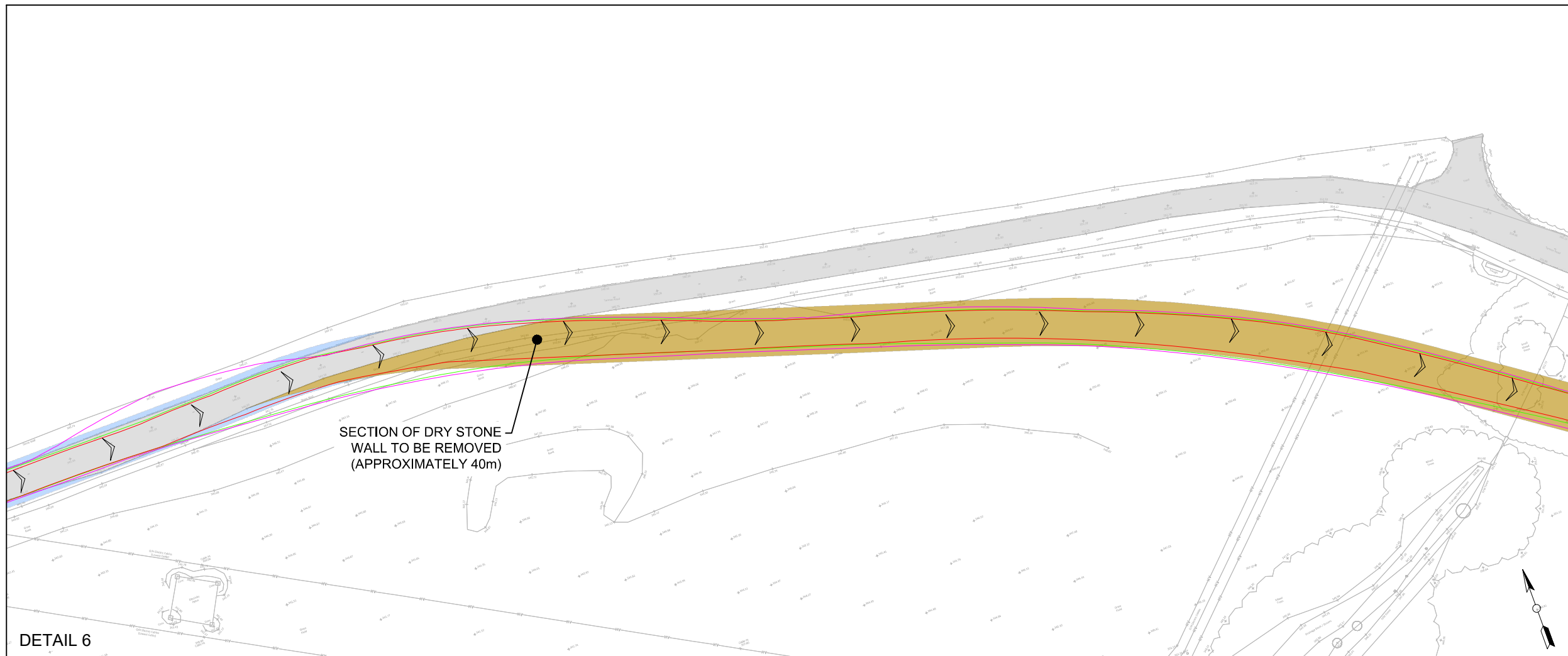

DETAIL 6

DETAIL 5 AND 6  
SHEET 4 OF 7

<small>LAYOUT DWG</small> N/A	<small>T-LAYOUT NO.</small> N/A
<small>DRAWING NUMBER</small> <b>04412-RES-ACC-DR-LO-009</b>	<small>REV</small> <b>1</b>

SCALE - 1:500 @ A3

**ENVIRONMENTAL STATEMENT  
2023**

THIS DRAWING IS THE PROPERTY OF RENEWABLE ENERGY SYSTEMS LTD. AND NO REPRODUCTION MAY BE MADE IN WHOLE OR IN PART WITHOUT PERMISSION

**MYNYDD MAEN  
WIND FARM**

**FIGURE 10.3**

**ABNORMAL LOAD ROUTE  
ABERCARN MOUNTAIN RD**

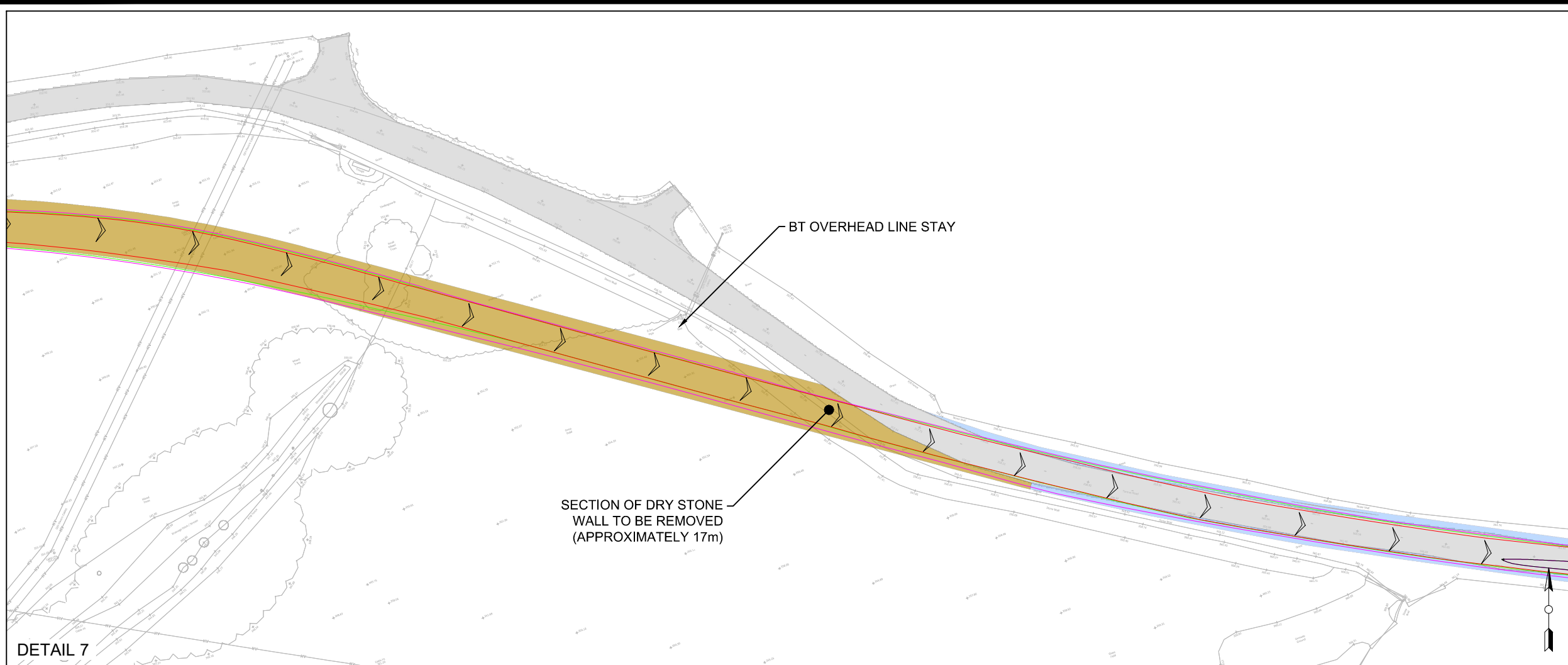

KEY:

- EXISTING ROAD / TRACK SURFACE
- PROPOSED ACCESS TRACK (ABNORMAL DELIVERY VEHICLES ONLY)
- POTENTIAL ROAD WIDENING FOR ABNORMAL DELIVERY VEHICLES
- PROPOSED PASSING BAY

VEHICLE TRACKING:

- WHEEL EXTENTS
- CHASSIS/BODY EXTENTS
- LOAD (BLADE) EXTENTS
- DIRECTION OF DELIVERY

NOTES:

REFER TO SHEET 1

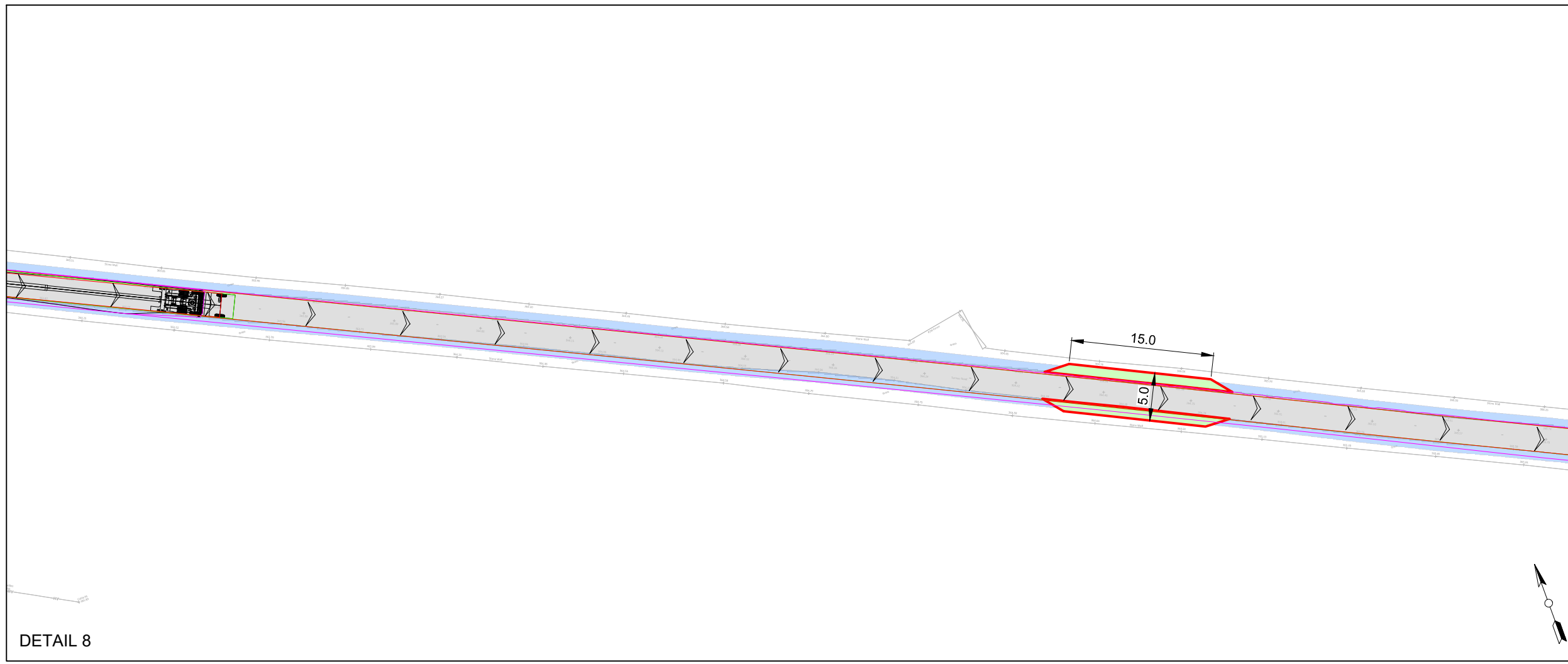

DETAIL 7 AND 8  
SHEET 5 OF 7

LAYOUT DWG	N/A	T-LAYOUT NO.	N/A
------------	-----	--------------	-----

DRAWING NUMBER	04412-RES-ACC-DR-LO-009	REV	1
----------------	-------------------------	-----	---

SCALE - 1:500 @ A3

**ENVIRONMENTAL STATEMENT  
2023**

THIS DRAWING IS THE PROPERTY OF RENEWABLE ENERGY SYSTEMS LTD. AND NO REPRODUCTION MAY BE MADE IN WHOLE OR IN PART WITHOUT PERMISSION

**MYNYDD MAEN  
WIND FARM**

**FIGURE 10.3**

**ABNORMAL LOAD ROUTE  
ABERCARN MOUNTAIN RD**

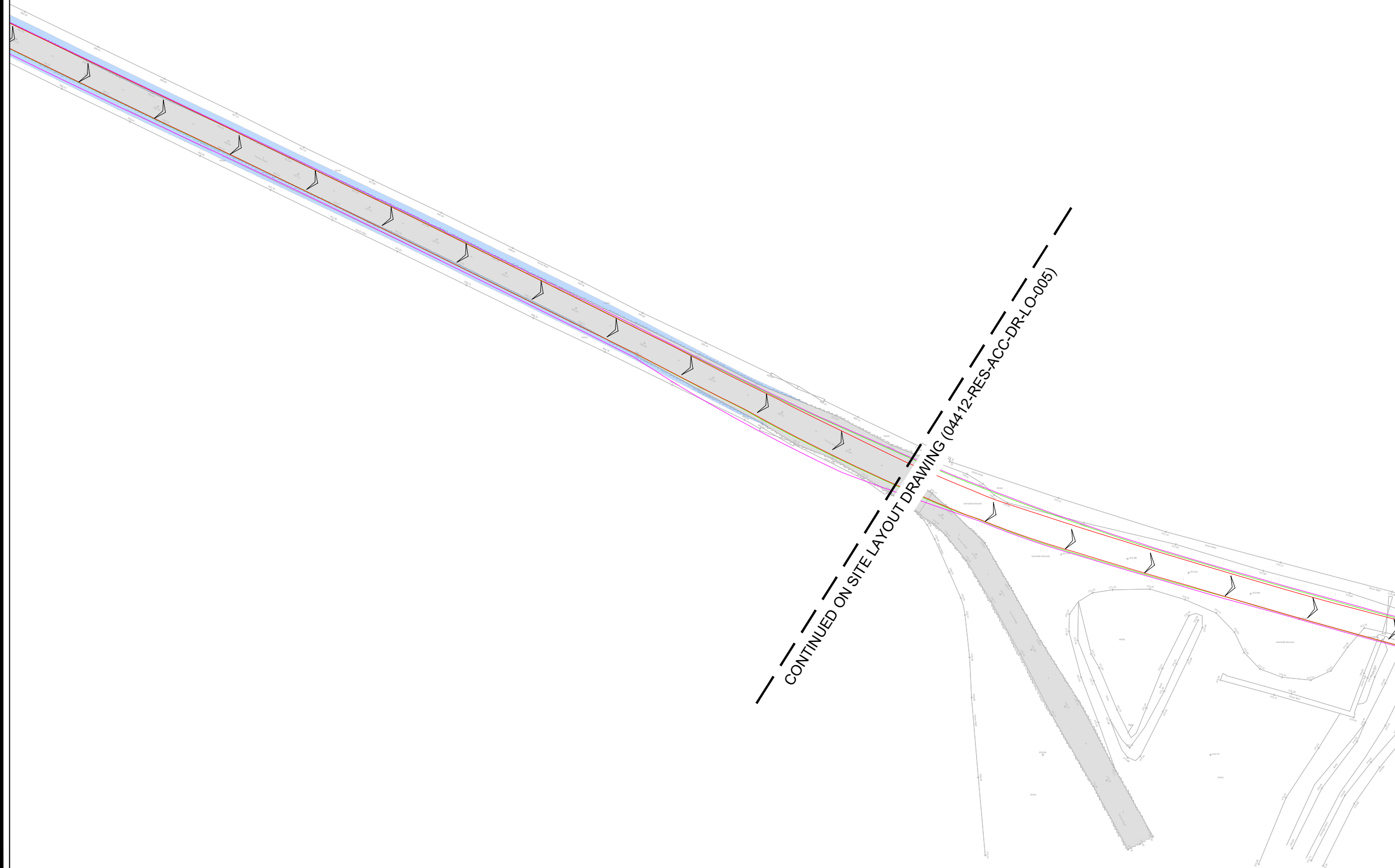

- KEY:**
- EXISTING ROAD / TRACK SURFACE
  - PROPOSED ACCESS TRACK (ABNORMAL DELIVERY VEHICLES ONLY)
  - POTENTIAL ROAD WIDENING FOR ABNORMAL DELIVERY VEHICLES
  - PROPOSED PASSING BAY
- VEHICLE TRACKING:**
- WHEEL EXTENTS
  - CHASSIS/BODY EXTENTS
  - LOAD (BLADE) EXTENTS
  - DIRECTION OF DELIVERY

**NOTES:**  
REFER TO SHEET 1

DETAIL 9  
SHEET 7 OF 7

<small>LAYOUT DWG</small> N/A	<small>T-LAYOUT NO.</small> N/A
-------------------------------	---------------------------------

<small>DRAWING NUMBER</small> <b>04412-RES-ACC-DR-LO-009</b>	<small>REV</small> <b>1</b>
---	--------------------------------

**SCALE - 1:500 @ A3**

**ENVIRONMENTAL STATEMENT  
2023**

THIS DRAWING IS THE PROPERTY OF RENEWABLE ENERGY SYSTEMS LTD. AND NO REPRODUCTION MAY BE MADE IN WHOLE OR IN PART WITHOUT PERMISSION

